

OPERATING INSTRUCTIONS

PRINCE CASTLE INC. 

Vertical Contact Toaster 197-BK, 296 & 297 Series



TABLE OF CONTENTS	PAGE
Installation	2
Operation	2
Adjustments	3
Cleaning	4
Parts List	5-8
Troubleshooting	8
Wiring Diagram	8

LIMITED WARRANTY

This product is warranted to be free from defects in material and/or workmanship for a period of two (2) years from date of original installation, not to exceed 30 months from date of shipment from our factory. Any part or component which proves to be faulty in material and/or workmanship within the warranty period will be replaced or repaired (at the option of Prince Castle, Inc.) without cost to the customer for parts or labor.

This warranty is subject to the following exceptions/conditions:

- Service must be performed by an authorized Prince Castle Service Center.
- Any use of non-genuine Prince Castle spare parts voids this warranty.
- On-location service is covered for one year from date of installation.
- All labor shall be performed during regular working hours. Overtime premium will not be covered.
- Damage caused by carelessness, neglect, and/or abuse (e.g., using wrong current, dropping, tampering with or altering electrical components, or improper cleaning) is not covered by the terms of this warranty. Equipment damaged in shipment, by fire, flood or an act of God is not covered.
- Normal adjustments as outlined in this manual are not covered under warranty.
- Motors that fail due to the lack of monthly lubrication may not be covered under warranty.



ELECTRICAL SPECIFICATIONS

Volts	Hz	Watts	Amps
110/120	60	1700	15.5
220	50/60	1700	7.39

PRINCE CASTLE INC. 
WORLDWIDE

355 East Kehoe Blvd. • Carol Stream, IL 60188
Tel: (630) 462-8800 • Fax: (630) 462-1460
Toll Free: 1-800-PCASTLE

INSTALLATION

1. After you have removed the toaster from the carton, inspect the unit for signs of damage. If there is damage to the unit:
 - Notify carrier within 24 hours after delivery.
 - Save carton and packing material for inspection purposes.
 - Contact your Prince Castle dealer or the Prince Castle Customer Sales Department at 1-630-462-8800 if purchased directly.
2. Verify that all parts have been received.
 - Slim-Line Bun Toaster and conveyor assembly.
 - Release Sheet Kit—located in a 14" box.
 - Crumb Tray—taped to the front of the conveyor.
3. Place toaster on flat surface. Remove protective covering.
4. Lift conveyor off conveyor guide rails and set aside. Remove all packing materials (nylon tape, foam block, plastic coating on sheet metal, and black rubber packaging spacers) from conveyor and conveyor guides.

Conveyor Guides



5. Place the teflon sheet over the top of the platen housing, making sure to have three inches of overhang.

3-inch Overhang

Release Sheet

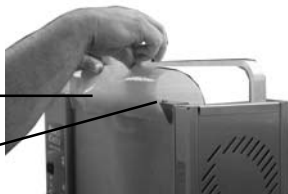

6. Slide the release sheet holding bracket onto the top of the platen housing.

Holding Bracket



7. Attach conveyor to the toaster by sliding the four pins (conveyor slides) on the conveyor housing into the four conveyor guides. Lower the conveyor housing until it is securely in place.
8. Hook the back end of the crumb tray onto the bar located below the conveyor assembly.
9. Plug unit into a properly grounded receptacle.

OPERATION

1. Turn the Power switch to the "On" position. The orange indicator light will illuminate. Allow 45 minutes for platen to reach operating temperature.

Power Switch



2. Place a sample run of the product being toasted into the top of the conveyor housing. The side to be toasted should face the platen.



3. The toasted product will be dispensed automatically from the bottom of the conveyor assembly.
4. Verify that product meets acceptable standards. If not, see adjustment section.

ADJUSTMENTS

Conveyor and Motor Gears:

There will be a small clearance between the conveyor gear and motor gear when properly aligned. Improper alignment will cause the conveyor to periodically bind.

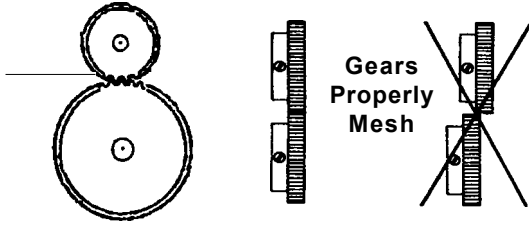

Tools Needed: 3/32" Allen wrench
Wicking grade thread locking fluid

1. Working from the "back side" of the toaster, loosening the 2 setscrews at the bottom of the conveyor guide until they are even with the conveyor stop. Note: the conveyor assembly may need to be removed for easier access.
2. Use the Allen Wrench to tighten the left setscrew (end housing side) until the setscrew just touches the conveyor slide.

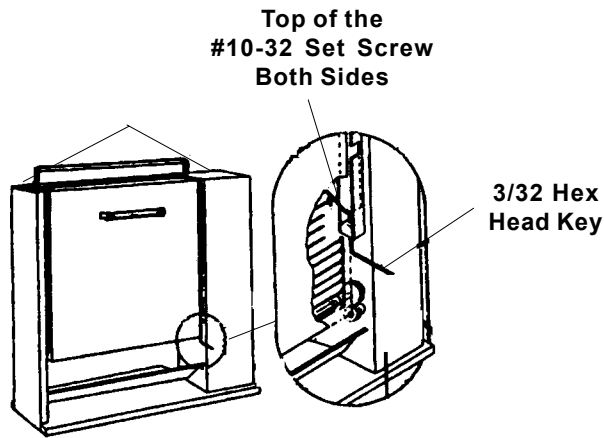

3. Tighten the right set screw (motor housing side) until the bottom of the conveyor housing is parallel to the top of the base.
4. Carefully tighten each setscrew another 1/2 turn.
5. Remove the conveyor assembly.
6. Apply a drop of wicking grade thread locking fluid to each setscrew.
7. Replace conveyor assembly

Bun Compression:

The toaster platen can be adjusted to provide the necessary compression needed on various products.

- Turn the two platen adjustment knobs clockwise to compensate for use on thicker bread products. Turn the two platen adjustment knobs counter clockwise for thinner products. The numbers on the front of the end and motor housing will indicate the settings, 1 for thinnest product, 5 for thickest.

Thermostat Knob

Platen Adjustment Knobs

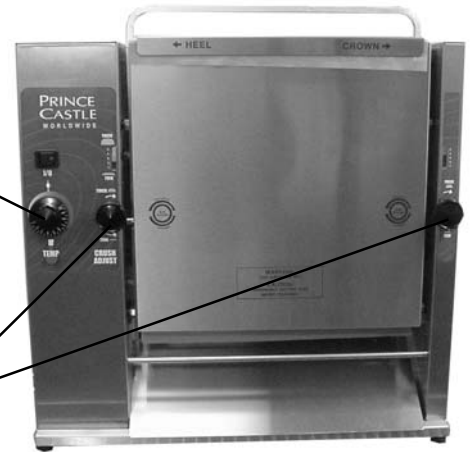

THICKER

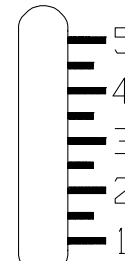

THINNER

Platen Temperature:

The temperature of the platen can be adjusted to compensate for darker or lighter toasting requirements.

- Turn the thermostat adjustment knob clockwise for darker toasting. Turn the thermostat adjustment knob counter clockwise for lighter toasting.

IMPORTANT: Allow 15 minutes for toaster to stabilize after adjusting the thermostat.

CLEANING



CAUTION: This is not jet-water approved, and should not be cleaned with a water hose or jet spray.



CAUTION: Do not immerse in water.

1. Turn off both the heater and motor switches and unplug the toaster.
2. Allow platen to cool for 60 minutes before cleaning.
3. Remove the conveyor assembly.
4. Wipe the conveyor with a damp cloth. For the chain use a soft bristle brush.
5. Remove the release sheet and lay it on a flat surface. Thoroughly clean both sides with a damp cloth making sure all carbon build up is removed. Allow to air dry.

IMPORTANT: Rotate two sheets daily for longer life. Sheets last 4-6 months based on care and volume of product toasted.

6. Use a damp cloth to remove any carbon build up on the platen surface.

IMPORTANT: Do not use sharp objects, scotch brite pads, scouring pads, or abrasive cleaners on the platen, or teflon release sheets as it will cause irreparable damage.

PREVENTIVE MAINTENANCE (MOTOR)

Note: See the drawing for oil port hole location. To extend the life of your motor, have a factory authorized service technician add 2-3 drops high temperature motor oil on a monthly basis.

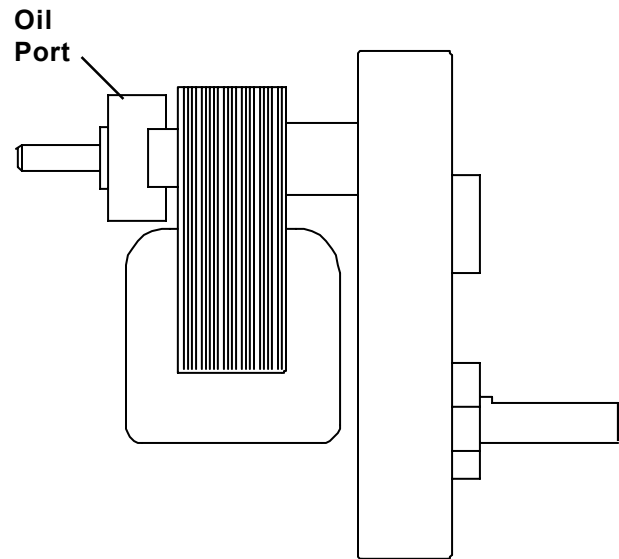

FRONT VIEW

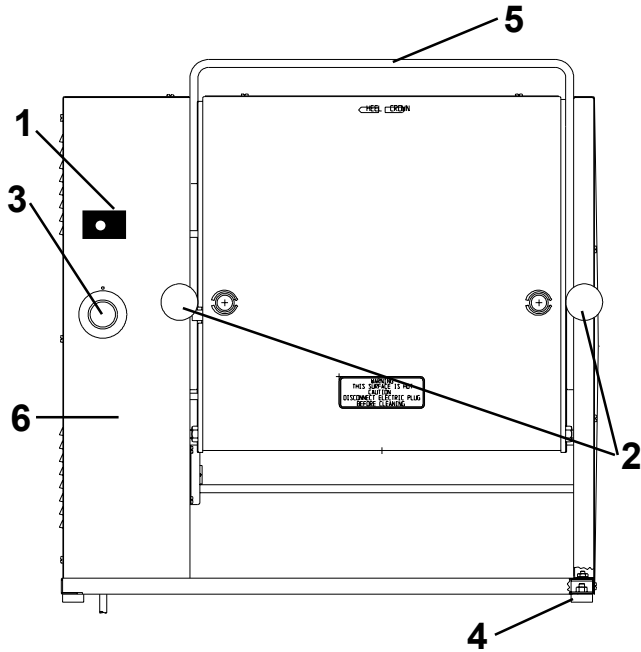

PARTS LIST

ITEM	PART NUMBER	DESCRIPTION
1	78-184S	Power Lighted Rocker Switch
2	197-185S	Platen Adjustment Knob (Pkg of 2)
3	70-012	Thermostat Knob
4	197-232	Foot
5	197-124	Conveyor Guide
6	197-472	Motor Housing
*	197-475	Overlay Motor Housing
*	197-491	Overlay Motor Housing (197-BK)
*	197-484	Overlay End Housing
*	197-259	Release Sheet Conversion Kit, 197/297
*	197-402	Release Sheet Conversion Kit, 296
*	197-260	Release Sheets (Pkg of 2), 197/297
*	297-151	Release Sheet (Pkg. of 4) 297-T12PHH only
*	297-149	Release Sheet Holder 297-T12PHH only

*Items Not Shown

INTERNAL COMPONENTS

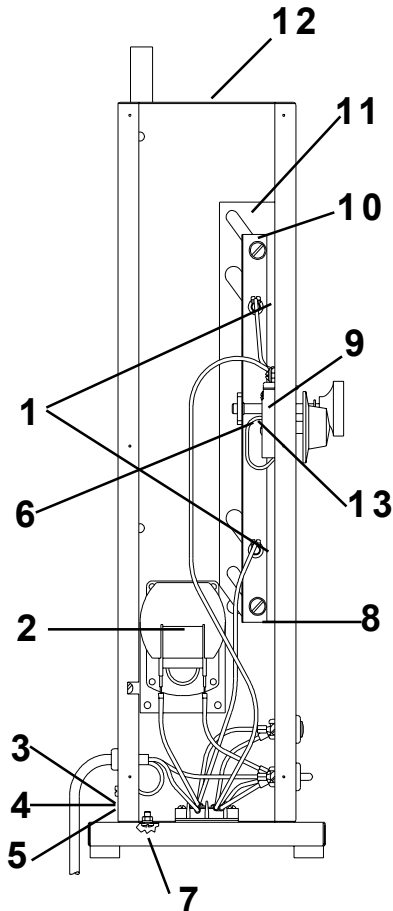

ITEM	PART NUMBER	DESCRIPTION
1	76-300	Slotted Pan Head Screw
2	87-029S	Motor (120 Volt)
	87-028AS	Motor (200-240 Volt)
3	73-031	Hex Nut
4	79-033	Washer
5	76-051	Slotted Binder Head Screw
6	79-055	Flat Washer
7	76-040	Slotted Binder Head Screw
	79-017	Split Lock Washer
	73-030	Hex Nut
8	76-150	Slotted Pan Head Screw
	79-094	Flat Washer
9	79-016	Flat Washer
	76-095	Slotted Binder Head Screw
10	197-90	L. H. Side Plate Weldment w/ Adjustment Screw
	197-89	R.H. Slide Plate Bracket w/Adjustment Screw
11	197-428	Baffle (Motor Housing)
	197-429	Baffle (End Housing)
12	196-19	Housing
13	197-140	Thermostat With Knob

CONVEYOR ASSEMBLY

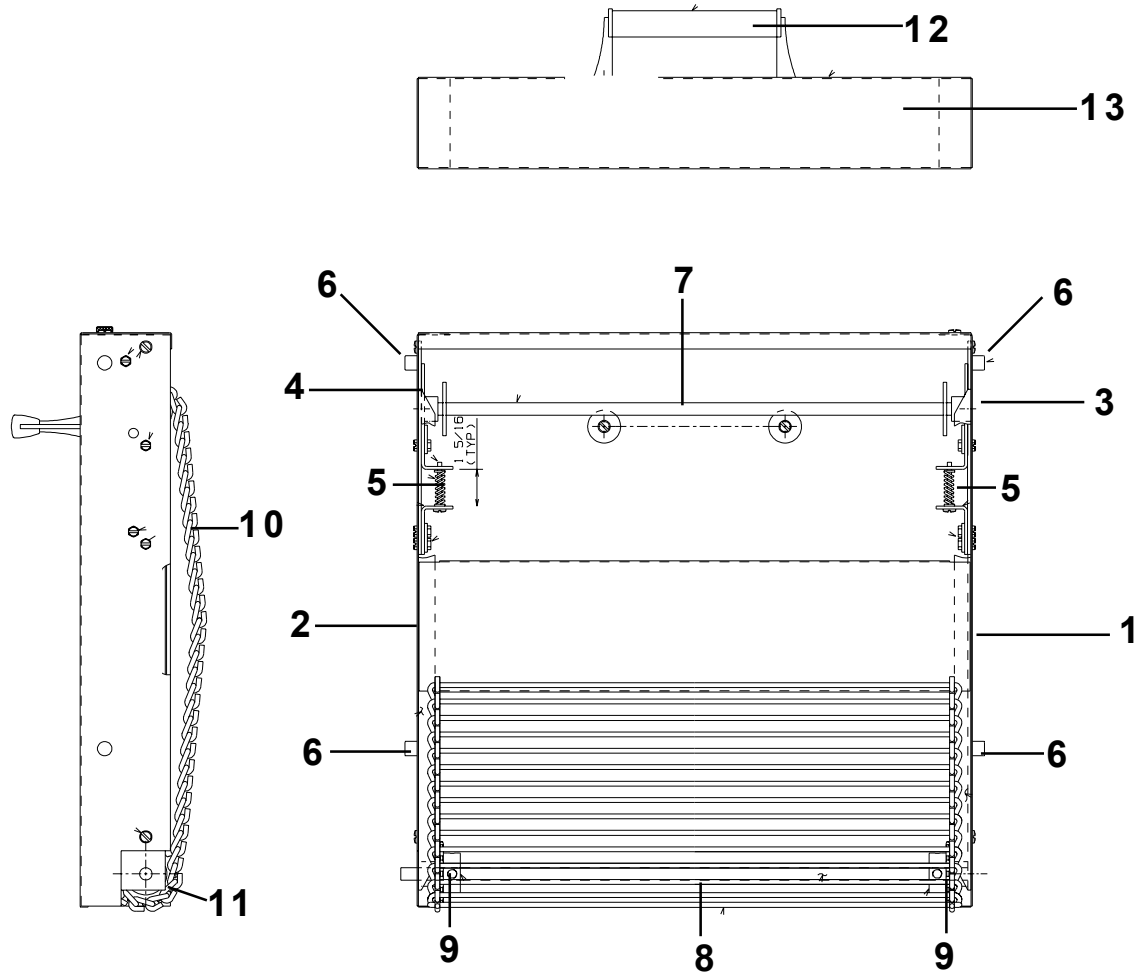

PARTS LIST

ITEM	PART NUMBER	DESCRIPTION
1	197-461	Right Side Shaft Carrier Assy.
2	197-463	Left Side Shaft Carrier Assy.
3	197-459	Right Side Shaft Carrier Adjustment Assy.
4	197-457	Left Side Shaft Carrier Adjustment Assy.
5	81-015	Compression Spring
6	197-467	Conveyor Slide
7	197-280	Shaft Assy.
8	197-465	Driven Shaft
9	197-302	Sprocket Kit (Pkg of 2)
10	89-684	Complete Chain Assy.
11	89-590	Single Conveyor Chain Link
12	197-7S	Black Handle With Screw
13	197-455S	Complete Conveyor Assy.
*	297-089	Reflector (Not Shown)

REAR VIEW

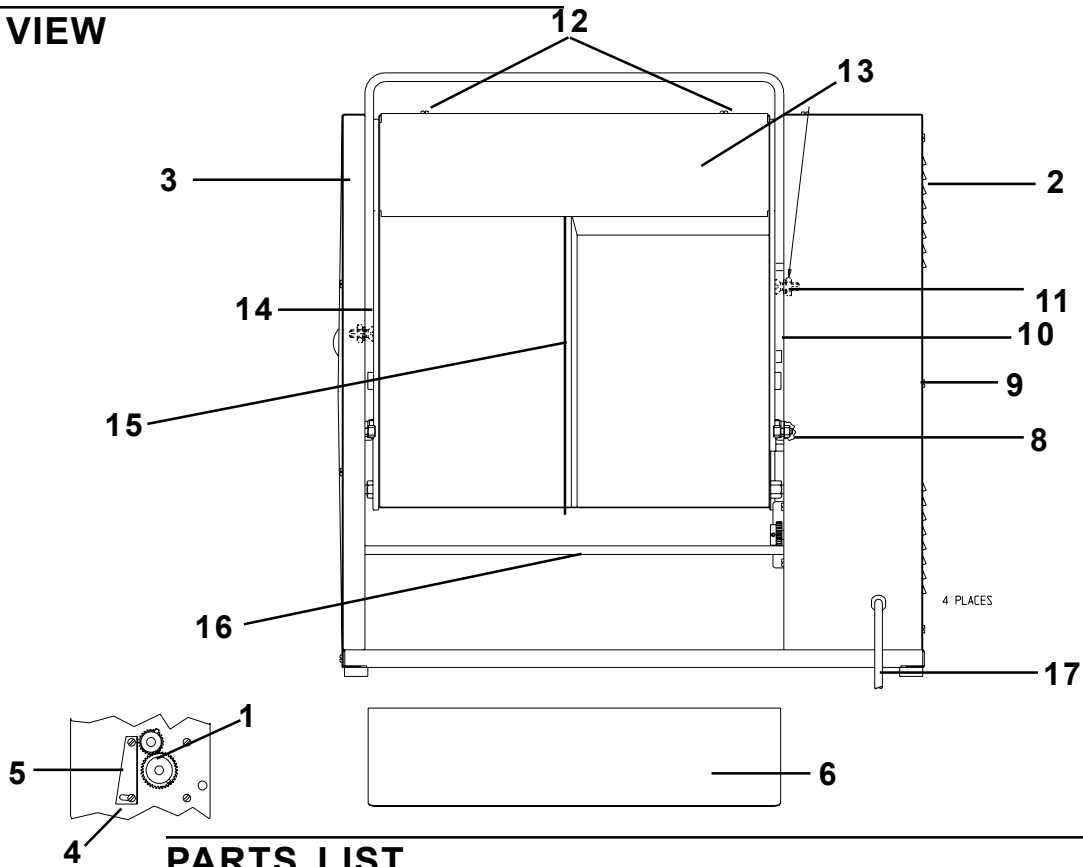

PARTS LIST

ITEM	PART NUMBER	DESCRIPTION
1	197-436S 197-476S 197-477S 197-437S 196-026S	Gear Kit (20/40Second) Gear Kit (12 Second) Gear Kit (14 Second) Gear Kit (30 Second) Gear Kit (55 Second)
2	197-114	Motor Cover
3	197-473	End Housing
4	76-225	Slotted Pan Head Screw
5	197-131	Guard
6	197-33 197-497	Crumb Tray Crumb Tray, 297-T12PHH
8	73-007 197-16 76-165	Hex Nut Conveyor Stop Set Screw
9	76-640	Screw
10	197-96	Left Side Bun Fence
11	73-008 73-030 79-016 76-033	Self Locking Hex Nut Hex Nut Flat Washer Slotted Flat Head Screw
12	76-640	Screw
13	197-13	Lead Pan Weldment
14	197-97	Right Bun Fence
15	197-430S 197-431S 196-023S 297-032S	Platen (120 Volt) (297) Platen (220-230 Volt) (297) Platen (120 Volt) (296) Platen (200 Volt) (297)
16	197-95	Tray Support
17	72-280S 72-332S	Line Cord Line Cord (Canada)
*	297-505	Instruction Card For 297-T12PHH

WIRING DIAGRAM

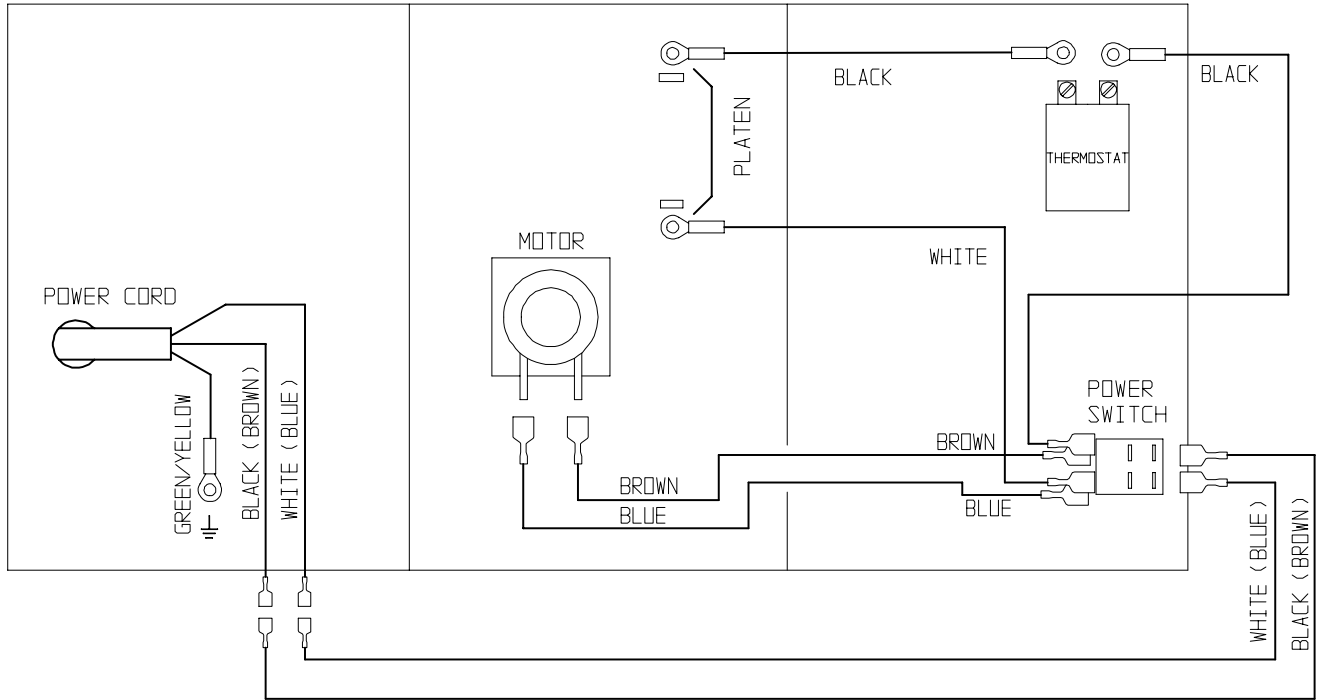

TROUBLE SHOOTING

PROBLEM	CAUSE	SOLUTION
Unit will not heat up. Power rocker switch light off.	No power to unit. Inoperable power cord. Loose connection on power switch. Inoperable power switch.	Ensure power cord is connected to proper Receptacle and the power inlet. Replace power cord. Tighten power switch connections. Replace power switch.
Unit will not heat up. Power rocker switch light on.	Inoperable thermostat. Inoperable platen.	Replace thermostat. Replace platen.
Unit heats up, but the conveyor does not run.	Loose motor switch connection. Inoperable motor. Stripped drive gear. Loose chain sprockets Gears not meshing. Inoperable motor switch.	Tighten motor switch connection. Replace motor. Replace drive gear. Adjust and tighten sprockets. Adjust conveyor set screws (See Conveyor Adjustments on page 3). Replace switch.
Unit under and over heats (does not respond to thermostat adjustments).	Inoperable thermostat.	Replace thermostat.
Buns under or over done.	Check platen adjustment. (See Platen Adjustments on page 3). Check platen temperature. (See Thermostat Adjustment on page 3).	Adjust platen for proper compression Adjust thermostat for proper temperature.